



PE182T-1-8C

CRUSHER DUTY ELECTRIC MOTOR

NEMA PREMIUM EFFICIENCY

TOTALLY ENCLOSED FAN COOLED

INVERTER DUTY 10:1 CT; 20:1 VT - NEMA MG1 PART 31

Factory Certified for T2B Class I, Division II, Groups A,B,C & D and Class II, Division II, Groups F & G

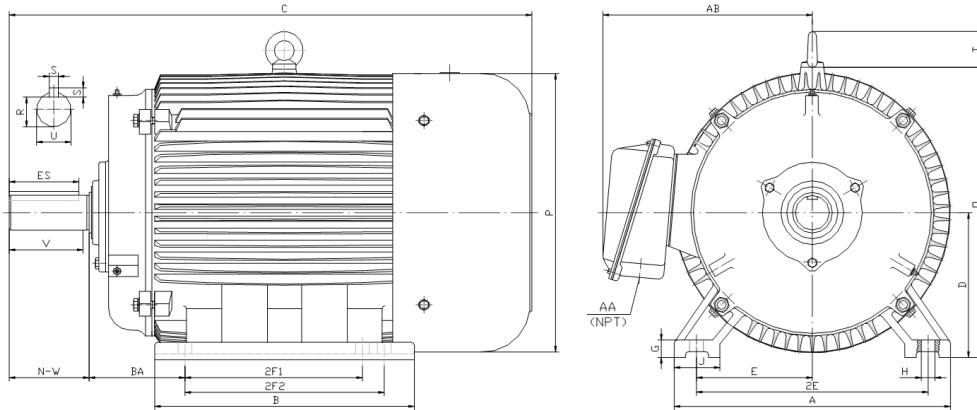

DIMENSIONS

HP	RPM	Frame	MOUNTING														
			A	B	C	D	G	H	J	E	2E	2F1	2F2	O	P	T	BA
1	900	182T	9.5	6.3	15.1	4.5	0.6	0.41	2	3.75	7.5	4.5	NA	9.1	8.7	1.6	2.75

Shaft Extension, Key Set						Conduit Box		Bearings		Mount
U	V	R	S	ES	N-W	AA	AB	DE	ODE	
1.125	2.5	0.986	0.25	1.78	2.75	0.75	7.5	6306-ZZ	6306-ZZ	F1

BEARING LUBRICATION: The bearings come lubricated with Mobil Polyrex EM Polyurea Grease.





PE182T-1-8C

CRUSHER DUTY ELECTRIC MOTOR

NEMA PREMIUM EFFICIENCY

TOTALLY ENCLOSED FAN COOLED

INVERTER DUTY 10:1 CT; 20:1 VT - NEMA MG1 PART 31

Factory Certified for T2B Class I, Division II, Groups A,B,C & D and Class II, Division II, Groups F & G

PERFORMANCE DATA

HP	RPM	Frame	Voltage	Frequency (Hz)	Full Load S.F.	Insulation Class	NEMA Design	Slip (%)	NEMA Code	Enclosure Type	IP Rating	Max. Ambient
1	870	182T	208-230/460	60	1.15	F	C	3.3	M	TEFC	55	40 °C

Amps (460V)		Efficiency (%)			Power Factor			Torque (ft-lb)			DE Bearing	ODE Bearing	Connection	Weight (lbs.)
FLA	LRA	100%	75%	50%	100%	75%	50%	FLT	LRT %	BDT %	6306-ZZ	6306-ZZ	9 Lead 2Y/Y	67
1.9	15	75.5	74.0	70.0	0.66	0.55	0.42	6.1	230	320				

NAME PLATE

		AC INDUCTION MOTOR INVERTER DUTY 20:1 VT; 10:1 CT								CONNECTION DIAGRAMS			
CAT NO.		PE182T-1-8C				FRAME		182T		PHASE 3			
HZ	60	S.F.	1.15	HZ	50	S.F.	1.0	ENCL	TEFC	IP	55		
HP	1	RPM	870	HP	1	RPM	730	DUTY CONT	DES	C			
VOLTS		208-230/460			VOLTS		190/380		AMB	40 °C		INS	F
AMPS		4.2 - 3.8 / 1.9			AMPS		4.6/2.3		DE BRG	6306-ZZ			
CODE	M	P.F.	0.66	CODE	K	P.F.	0.68	ODE BRG	6306-ZZ				
EFF	75.5	MIN	72.0	EFF	72.5	MIN	68.5	LUB:	Mobil Polyrex EM				
MOTOR WEIGHT	67	LBS		CONNECTION	9 Lead 2Y/Y			SER NO					
Special purpose use on crushing and pulverizing equipment. Hernando, Mississippi										CC082A			

APPLICATIONS:

Special purpose use on crushing and pulverizing equipment. Other industrial machinery requiring extremely high starting torques and breakdown torques. Suitable for use with variable frequency drives.