



PE213TC-7.5-2-AI

GENERAL PURPOSE ELECTRIC MOTOR

NEMA PREMIUM EFFICIENCY

THREE PHASE, TOTALLY ENCLOSED FAN COOLED - C-FLANGE W/ FEET

INVERTER DUTY 10:1 CT; 20:1 VT - NEMA MG1 PART 31

Factory Certified for T2B Class I, Division II, Groups A,B,C & D and Class II, Division II, Groups F & G

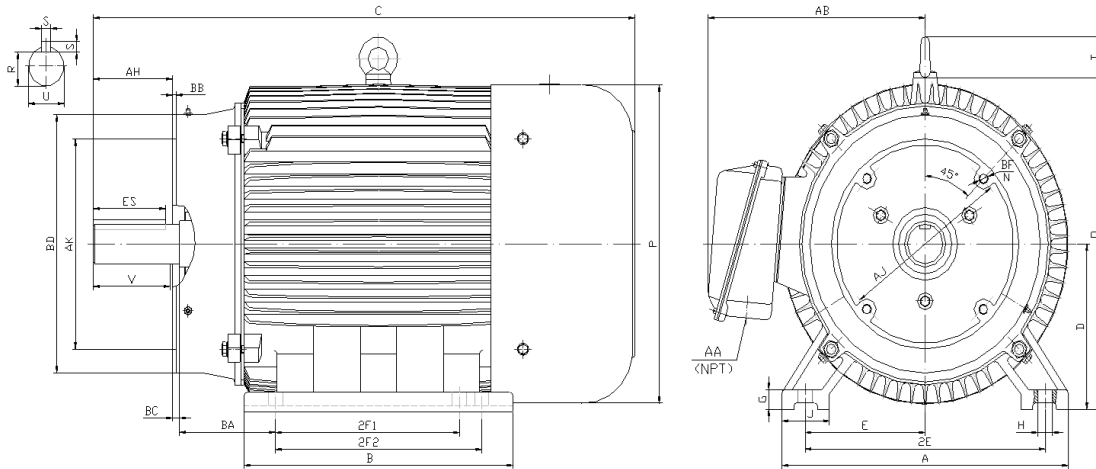

DIMENSIONS

HP	RPM	Frame	MOUNTING														
			A	B	C	D	G	H	J	E	2E	2F1	2F2	O	P	T	BA
7.5	3600	213TC	10.50	9.37	20.70	5.25	0.70	0.41	2.16	4.25	8.50	5.50	7.00	11.37	11.70	1.73	3.50

FLANGE							Shaft Extension, Key Set						Conduit Box		Bearings		Mount
AH	AJ	AK	BB	BC	BD	BF	U	V	R	S	ES	N-W	AA	AB	DE	ODE	
3.12	7.250	8.50	0.25	0.25	9.00	4*1/2-13	1.375	3.12	1.201	0.312	2.41	3.38	1.00	9.80	6208-ZZ	6208-ZZ	F1

BEARING LUBRICATION: The bearings come lubricated with Mobil Polyrex EM Polyurea Grease.





PE213TC-7.5-2-AI

GENERAL PURPOSE ELECTRIC MOTOR

NEMA PREMIUM EFFICIENCY

THREE PHASE, TOTALLY ENCLOSED FAN COOLED - C-FLANGE W/ FEET

INVERTER DUTY 10:1 CT; 20:1 VT - NEMA MG1 PART 31

Factory Certified for T2B Class I, Division II, Groups A,B,C & D and Class II, Division II, Groups F & G







PERFORMANCE DATA

HP	RPM	Frame	Voltage	Frequency (Hz)	Full Load S.F.	Insulation Class	NEMA Design	Slip (%)	NEMA Code	Enclosure Type	IP Rating	Max. Ambient
7.5	3525	213TC	230/460	60	1.15	F	B	2.1	H	TEFC	55	40° C

Amps (460V)		Efficiency (%)				Power Factor			Torque (ft-lb)			DE Bearing	ODE Bearing	Connection	Weight (lbs.)
FLA	LRA	100%	75%	50%	Min.	100%	75%	50%	FLT	LRT %	BDT %				
8.8	63.0	89.5	89.7	89.2	87.5	0.910	0.920	0.880	11.2	180	300	6208-ZZ	6208-ZZ	9 Lead 2Y/Y	180

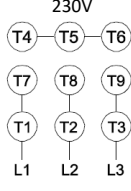
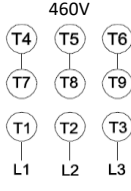
*Usable at 208 Volts

NAME PLATE

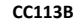
										AC INDUCTION MOTOR INVERTER DUTY 20:1 VT; 10:1 CT																				CONNECTION DIAGRAMS									
CAT NO: PE213TC-7.5-2-AI					FRAME 213TC					PHASE 3																													
HZ 60		S.F. 1.15		HZ 50		S.F. 1.0		ENCL TEFC		IP 55																													
HP 7.5		RPM 3525		HP 7.5		RPM 2930		DUTY CONT		DES B																													
VOLTS 230/460					VOLTS 190/380					AMB 40° C															INS F														
FLA 17.6 / 8.8					FLA 20.6/10.3					DE BEARING 6208-ZZ																													
CODE H					P.F. 0.91					CODE J															P.F. 0.91					ODE BEARING 6208-ZZ									
EFF 89.5					MIN 87.5					EFF 88.5															MIN 86.5					LUB: Mobil Polyrex EM									
MOTOR WEIGHT 180 LBS					CONNECTION 9 Lead 2Y/Y					SER NO																													
General purpose use on industrial machinery installed in damp, dusty or dirty environments. Hernando, Mississippi										   																													

APPLICATIONS:

General purpose use on pumps, fans, blowers, compressors, conveyors, material handling and other industrial machinery installed in damp, dusty or dirty environments.