



## PE254TC-7.5-6

GENERAL PURPOSE ELECTRIC MOTOR

NEMA PREMIUM EFFICIENCY

TOTALLY ENCLOSED FAN COOLED - C-FLANGE WITH FEET

INVERTER DUTY 10:1 CT; 20:1 VT - NEMA MG1 PART 31

Factory Certified for T2B Class I, Division II, Groups A,B,C & D and Class II, Division II, Groups F & G

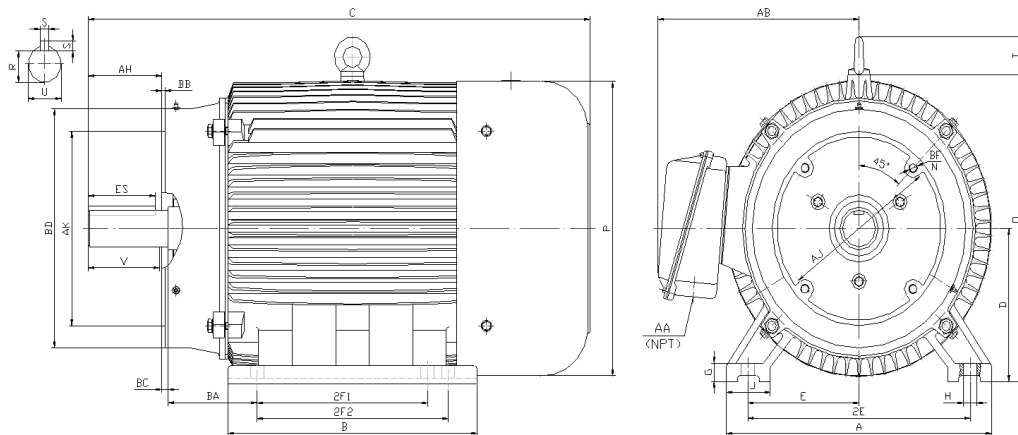

### DIMENSIONS

HP	RPM	Frame	MOUNTING														
			A	B	C	D	G	H	J	E	2E	2F1	2F2	O	P	T	BA
7.5	1200	254TC	13	10.45	23.2	6.25	0.7	0.53	2.75	5	10	8.25	NA	13.2	12.8	2.2	4.25

FLANGE							Shaft Extension, Key Set					
AH	AJ	AK	BB	BC	BD	BF	U	V	R	S	ES	N-W
3.75	7.25	8.5	0.25	0.25	10	4*1/2-13	1.625	3.75	1.416	0.375	2.91	NA

Conduit Box		Bearings		Mount
AA	AB	DE	ODE	
1.25	10.3	6309	6309	F1

**BEARING LUBRICATION:** The bearings come lubricated with Mobil Polyrex EM Polyurea Grease. It is recommended that you add some additional lubrication when the motor is installed.

Three options (brands) for suitable lubrication include, but are not limited to, the following:

- 1.) Mobil Polyrex EM
- 2.) Citco Polyurea MP
- 3.) Conoco Phillips Polytac EP





## PE254TC-7.5-6

**GENERAL PURPOSE ELECTRIC MOTOR**

**NEMA PREMIUM EFFICIENCY**

**TOTALLY ENCLOSED FAN COOLED - C-FLANGE WITH FEET**

**INVERTER DUTY 10:1 CT; 20:1 VT - NEMA MG1 PART 31**

**Factory Certified for T2B Class I, Division II, Groups A,B,C & D and Class II, Division II, Groups F & G**

### PERFORMANCE DATA

HP	RPM	Frame	Voltage	Frequency (Hz)	Full Load S.F.	Insulation Class	NEMA Design	Slip (%)	NEMA Code	Enclosure Type	IP Rating	Max. Ambient
7.5	1185	254TC	230/460	60	1.15	F	B	1.3	H	TEFC	55	40 °C

Amps (460V)		Efficiency (%)			Power Factor			Torque (ft-lb)			DE Bearing	ODE Bearing	Connection	Weight (lbs.)
FLA	LRA	100%	75%	50%	100%	75%	50%	FLT	LRT %	BDT %				
9.8	63	91.0	91.0	89.5	0.74	0.66	0.53	33.65	185	280	6309	6309	12 Lead 2Δ/Δ	242

\*Usable at 208 Volts

### NAME PLATE

		<b>AC INDUCTION MOTOR</b> INVERTER DUTY 20:1 VT; 10:1 CT						<b>CONNECTION DIAGRAMS</b>			
<b>CAT NO.</b> PE254TC-7.5-6		<b>FRAME</b> 254TC		<b>PHASE</b> 3		<b>230V</b>					
<b>HZ</b> 60	<b>S.F.</b> 1.15	<b>HZ</b> 50	<b>S.F.</b> 1.0	<b>ENCL</b> TEFC	<b>IP</b> 55						
<b>HP</b> 7.5	<b>RPM</b> 1185	<b>HP</b> 7.5	<b>RPM</b> 980	<b>DUTY</b> CONT	<b>DES</b> B						
<b>VOLTS</b> 230/460		<b>VOLTS</b> 190/380		<b>AMB</b> 40 °C	<b>INS</b> F						
<b>AMPS</b> 19.6 / 9.8		<b>AMPS</b> 24/12		<b>DE BRG</b> 6309							
<b>CODE</b> H	<b>P.F.</b> 0.74	<b>CODE</b> G	<b>P.F.</b> 0.78	<b>ODE BRG</b> 6309							
<b>EFF</b> 91.0	<b>MIN</b> 89.5	<b>EFF</b> 89.0	<b>MIN</b> 87.5	<b>LUB:</b> Mobil Polyrex EM							
<b>MOTOR WEIGHT</b> 242 LBS		<b>CONNECTION</b> 12 Lead 2Δ/Δ		<b>SER NO</b>		<b>460V</b>					
General purpose use on industrial machinery installed in damp, dusty or dirty environments.								<b>CC082A</b>			
Hernando, Mississippi											

### APPLICATIONS:

General purpose use on pumps, fans, blowers, compressors, conveyors, material handling and other industrial machinery installed in damp, dusty or dirty environments.