



## PE286T-15-8C

**CRUSHER DUTY ELECTRIC MOTOR**

**NEMA PREMIUM EFFICIENCY**

**TOTALLY ENCLOSED FAN COOLED**

**INVERTER DUTY 10:1 CT; 20:1 VT - NEMA MG1 PART 31**

**Factory Certified for T2B Class I, Division II, Groups A,B,C & D and Class II, Division II, Groups F & G**

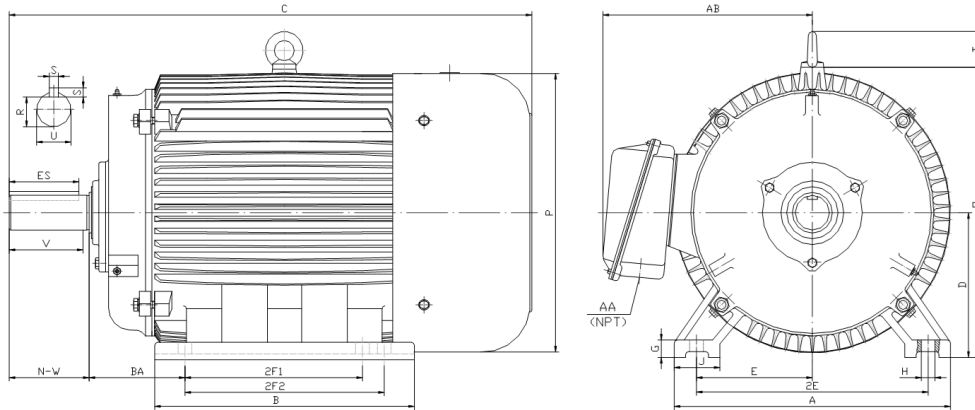

### DIMENSIONS

| HP | RPM | Frame | MOUNTING |      |      |   |      |      |      |     |    |     |     |      |    |     |      |
|----|-----|-------|----------|------|------|---|------|------|------|-----|----|-----|-----|------|----|-----|------|
|    |     |       | A        | B    | C    | D | G    | H    | J    | E   | 2E | 2F1 | 2F2 | O    | P  | T   | BA   |
| 15 | 900 | 286T  | 14       | 13.2 | 28.1 | 7 | 0.85 | 0.53 | 2.75 | 5.5 | 11 | 9.5 | 11  | 14.5 | 14 | 2.2 | 4.75 |

| Shaft Extension, Key Set |      |       |     |      |      | Conduit Box |      | Bearings |      | Mount |
|--------------------------|------|-------|-----|------|------|-------------|------|----------|------|-------|
| U                        | V    | R     | S   | ES   | N-W  | AA          | AB   | DE       | ODE  |       |
| 1.875                    | 4.38 | 1.591 | 0.5 | 3.28 | 4.62 | 1.5         | 11.3 | 6311     | 6311 | F1    |

**BEARING LUBRICATION:** The bearings come lubricated with Mobil Polyrex EM Polyurea Grease. It is recommended that you add some additional lubrication when the motor is installed.

Three options (brands) for suitable lubrication include, but are not limited to, the following:

- 1.) Mobil Polyrex EM
- 2.) Citco Polyurea MP
- 3.) Conoco Phillips Polytac EP





**PE286T-15-8C**

**CRUSHER DUTY ELECTRIC MOTOR**

**NEMA PREMIUM EFFICIENCY**

**TOTALLY ENCLOSED FAN COOLED**

**INVERTER DUTY 10:1 CT; 20:1 VT - NEMA MG1 PART 31**

**Factory Certified for T2B Class I, Division II, Groups A,B,C & D and Class II, Division II, Groups F & G**

**PERFORMANCE DATA**

| HP | RPM | Frame | Voltage | Frequency (Hz) | Full Load S.F. | Insulation Class | NEMA Design | Slip (%) | NEMA Code | Enclosure Type | IP Rating | Max. Ambient |
|----|-----|-------|---------|----------------|----------------|------------------|-------------|----------|-----------|----------------|-----------|--------------|
| 15 | 880 | 286T  | 230/460 | 60             | 1.15           | F                | C           | 2.2      | G         | TEFC           | 55        | 40 °C        |

| Amps (460V) |     | Efficiency (%) |      |      | Power Factor |      |      | Torque (ft-lb) |       |       | DE Bearing | ODE Bearing | Connection   | Weight (lbs.) |
|-------------|-----|----------------|------|------|--------------|------|------|----------------|-------|-------|------------|-------------|--------------|---------------|
| FLA         | LRA | 100%           | 75%  | 50%  | 100%         | 75%  | 50%  | FLT            | LRT % | BDT % |            |             |              |               |
| 21.5        | 116 | 89.5           | 89.0 | 87.5 | 0.73         | 0.59 | 0.45 | 89.5           | 200   | 280   | 6311       | 6311        | 12 Lead 2Δ/Δ | 352           |

\*Usable at 208 Volts

**NAME PLATE**

|   |                         |  |             |                       |       |          |  |        |  |                             |  |  |
|---|-------------------------|--|-------------|-----------------------|-------|----------|--|--------|--|-----------------------------|--|--|
|   |                         | AC INDUCTION MOTOR<br>INVERTER DUTY 20:1 VT; 10:1 CT |             |                       |       |          |  |        |  | CONNECTION DIAGRAMS<br>230V |  |  |
| CAT NO. PE286T-15-8C  |                         | FRAME 286T   |             | PHASE 3               |       |          |  |        |  |                             |  |  |
| HZ 60   | S.F. 1.15               | HZ 50  | S.F. 1.0    | ENCL TEFC             | IP 55 |          |  |        |  |                             |  |  |
| HP 15   | RPM 880                 | HP 15  | RPM 735     | DUTY CONT             | DES C |          |  |        |  |                             |  |  |
| VOLTS 230/460   |                         | VOLTS 190/380  |             | AMB 40 °C             | INS F |          |  |        |  |                             |  |  |
| AMPS 43 / 21.5  | AMPS 51.6/25.8          |  | DE BRG 6311 |                       |       |          |  |        |  |                             |  |  |
| CODE G  | P.F. 0.73               | CODE F   | P.F. 0.75   | ODE BRG 6311          |       |          |  |        |  |                             |  |  |
| EFF 89.5  | MIN 87.5                | EFF 87.5   | MIN 85.5    | LUB: Mobil Polyrex EM |       | 460V<br> |  |        |  |                             |  |  |
| MOTOR WEIGHT 352 LBS  | CONNECTION 12 Lead 2Δ/Δ |  | SER NO      |                       |       |          |  |        |  |                             |  |  |
| Special purpose use on crushing and pulverizing equipment.<br>Hernando, Mississippi |                         |  |             |                       |       |          |  | CC082A |  |                             |  |  |

**APPLICATIONS:**

Special purpose use on crushing and pulverizing equipment. Other industrial machinery requiring extremely high starting torques and breakdown torques. Suitable for use with variable frequency drives.