

PES143TC1.5M-2

WASHDOWN DUTY MOTOR

NEMA PREMIUM EFFICIENCY

STAINLESS STEEL CONSTRUCTION - C-FLANGE WITH FEET

TOTALLY ENCLOSED FAN COOLED - IP66 CONSTRUCTION

INVERTER DUTY 10:1 CT; 20:1 VT - NEMA MG1 PART 31

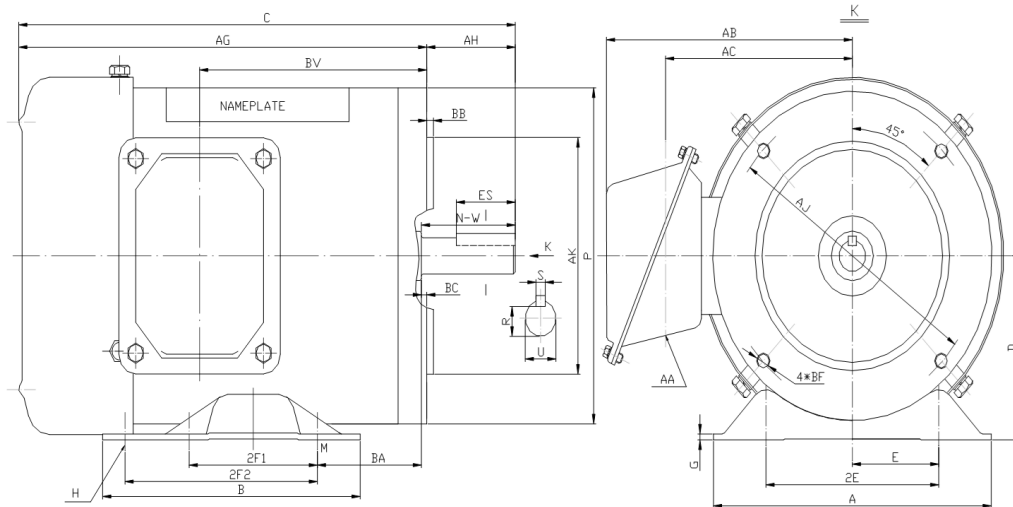

DIMENSIONS

HP	RPM	Frame	MOUNTING												
			A	B	C	D	G	H	E	2E	2F1	2F2	P	AG	BA
1.5	3600	143TC	6.5	6.5	13.81	3.5	0.118	0.35	2.75	5.5	4	5	6.5	11.69	2.75

FLANGE						Shaft Extension, Key Set					Conduit Box			
AH	AJ	AK	BB	BC	BF	U	R	S	ES	N-W	AA	AB	AC	BV
2.12	5.875	4.5	0.16	0.12	4*3/8-16	0.875	0.771	0.188	1.41	2.25	0.86	5.75	4.25	7.5

Bearings		Mount
DE	ODE	
6205-2RS	6205-2RS	F1

BEARING LUBRICATIONS: The sealed bearings come lubricated with NEVASTANE XS 80 Grease which complies with FDA Chapter 21 CFR 178.3570



PESS143TC1.5M-2

WASHDOWN DUTY MOTOR

NEMA PREMIUM EFFICIENCY

STAINLESS STEEL CONSTRUCTION - C-FLANGE WITH FEET

TOTALLY ENCLOSED FAN COOLED - IP66 CONSTRUCTION





INVERTER DUTY 10:1 CT; 20:1 VT - NEMA MG1 PART 31

PERFORMANCE DATA

HP	RPM	Frame	Voltage	Frequency (Hz)	Full Load S.F.	Insulation Class	NEMA Design	Slip (%)	NEMA Code	Enclosure Type	IP Rating	Max. Ambient
1.5	3480	143TC	208-230/460	60	1.15	F	B	3.3	K	TEFC	66	40 °C

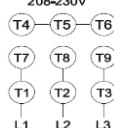
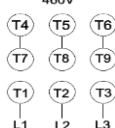
Amps (460V)		Efficiency (%)			Power Factor			Torque (ft-lb)			DE Bearing	ODE Bearing	Connection	Weight (lbs.)
FLA	LRA	100%	75%	50%	100%	75%	50%	FLT	LRT %	BDT %				
2	20	84.0	78.0	74.0	0.86	0.82	0.73	2.3	285	300	6205-2RS	6205-2RS	9 Lead 2Y/Y	40

NAME PLATE

		THREE PHASE AC INDUCTION MOTOR						Hernando, MS 38632					
INVERTER DUTY 20:1 VT; 10:1 CT													
Model :	PESS143TC1.5M-2					IP	66	FRAME	143TC	LB/WT	40		
HZ	60	S.F.	1.15	HZ	50	S.F.	1.0	NEMA DESIGN	B				
HP	1.5	RPM	3480	HP	1.5	RPM	2865	ENCL.	TEFC	INS	F		
VOLTS	208-230/460			VOLTS	190/380			DUTY	CONT	AMB	40 °C		
AMPS	4.2 - 4 / 2			AMPS	4.8/2.4			DE BRG	6205-2RS				
CODE	K	P.F.	0.86	CODE	K	P.F.	0.88	ODE BRG	6205-2RS				
EFF	84.0	MIN	81.5	EFF	81.5	MIN	78.5	SER NO.					
<div style="display: flex; justify-content: space-between;"> <div style="text-align: center;"> <p>208-230V</p>  </div> <div style="text-align: center;"> <p>460V</p>  </div> <div style="text-align: center;">    </div> <div style="text-align: center;"> <p>CC082A</p> <p>MADE IN CHINA</p> </div> </div>													

Factory Certified for T2B
Div 2. Class I, Gr. A , B , C & D
and Class II, Gr. F & G

APPLICATIONS:

Applications include washdown applications, food processing, chemical processing, pharmaceuticals, poultry processing, meat processing, dairy applications, bakeries, snack foods, bottling and extremely corrosive environments.