



PEXP184TC-5-4

EXPLOSION PROOF ELECTRIC MOTOR

NEMA PREMIUM EFFICIENCY

TOTALLY ENCLOSED FAN COOLED; EXPLOSION PROOF ENCLOSURE - C-FLANGE WITH FEET

CLASS I DIVISION I GROUP C & D; CLASS II DIVISION I GROUP F & G

T3C, with Ambient Temperature Rating: -20 ° C to 55 ° C @ 1.15 SF

T3C, with Ambient Temperature Rating: -20° C to 40° C @ 1.0 SF for Inverter Duty

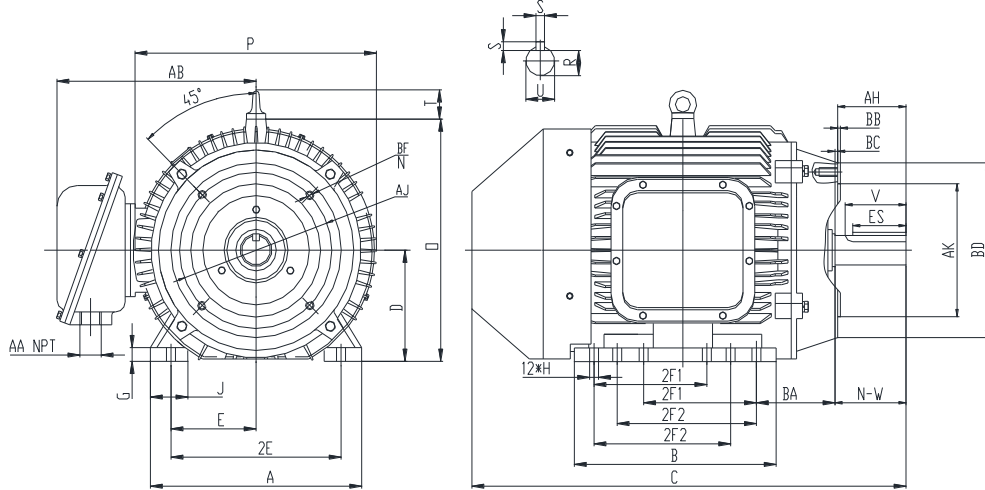

DIMENSIONS

HP	RPM	Frame	MOUNTING														
			A	B	C	D	G	H	J	E	2E	2F1	2F2	O	P	T	BA
5	1800	184TC	8.9	8.97	18.43	4.5	0.68	0.41	1.7	3.75	7.5	4.5	5.5	9.93	10.63	2.04	2.75

FLANGE							Shaft Extension, Key Set						
AH	AJ	AK	BB	BC	BD	BF	U	V	R	S	ES	N-W	
2.62	7.25	8.5	0.25	0.12	9	4*1/2-13	1.125	2.5	0.986	0.25	1.78	2.75	

Conduit Box		Bearings		Mount
AA	AB	DE	ODE	
0.75	9.41	6306-ZZ	6306-ZZ	F1

BEARING LUBRICATION: The bearings come lubricated with Mobil Polyrex EM Polyurea Grease.





PEXP184TC-5-4

EXPLOSION PROOF ELECTRIC MOTOR

NEMA PREMIUM EFFICIENCY

TOTALLY ENCLOSED FAN COOLED; EXPLOSION PROOF ENCLOSURE - C-FLANGE WITH FEET

CLASS I DIVISION I GROUP C & D; CLASS II DIVISION I GROUP F & G

T3C, with Ambient Temperature Rating: -20 ° C to 55 ° C @ 1.15 SF





T3C, with Ambient Temperature Rating: -20° C to 40° C @ 1.0 SF for Inverter Duty

PERFORMANCE DATA

HP	RPM	Frame	Voltage	Frequency (Hz)	Full Load S.F.	Insulation Class	NEMA Design	Slip (%)	NEMA Code	Enclosure Type	IP Rating	Max. Ambient	Oper Temp Code	Max. KVAR
5	1765	184TC	208-230/460	60	1.15	F	B	1.9	J	TEXP	55	40 °C	T3C	2.4

Amps (460V)		Max. Amps (208V)	Efficiency (%)			Power Factor			Torque (ft-lb)			DE Bearing	ODE Bearing	Connection	Weight (lbs.)
FLA	LRA	60Hz	100%	75%	50%	100%	75%	50%	FLT	LRT %	BDT %				
7	46	15.48	89.5	89.2	87.0	0.81	0.75	0.66	14.9	185	225	6306-ZZ	6306-ZZ	9 Lead 2Y/Y	183

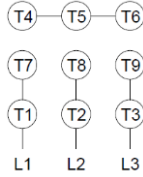
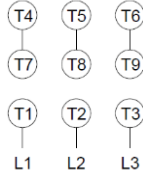
NAME PLATE

		AC INDUCTION MOTOR PREMIUM EFFICIENCY EXPLOSION-PROOF						CONNECTION DIAGRAMS								
CAT. NO. PEXP184TC-5-4		FRAME 184TC		RATING CONT		PHASE 3			208-230V 							
DE BRG. 6306-ZZ		ODE BRG. 6306-ZZ		LUB. Mobil Polyrex EM												
MAX. AMB. 40 °C		INS. CLASS F		CONN. 9 Lead 2Y/Y		SER.										
USABLE ON 208V 60HZ AT 15.5 MAX AMPS				ENCL TEXP		WEIGHT 183										
60 HERTZ DATA		HP 5		RPM 1765		HP 5		RPM 1471		50 HERTZ DATA						
		VOLTS 208-230/460				VOLTS 190/380										
		F.L. AMPS 15.5 - 14 / 7				F.L. AMPS 16.9/8.5										
		S.F. AMPS 8.05				S.F. AMPS 16.9/8.5										
		S.F. 1.15		DESIGN B		CODE J		S.F. 1.0					DESIGN B		CODE K	
		NEMA NOM.EFF 89.5		NOM. P.F. 0.81		NEMA NOM.EFF 88.4		NOM. P.F. 0.81								
NEMA MIN.EFF 87.5		MAX. KVAR 2.4		NEMA MIN.EFF 86.1						460V 						
General purpose use on industrial machinery installed in damp, dusty or dirty environments. These motors are designed for use in hazardous locations defined by class and group. Hernando, MS 38632				 CC041B												



PEXP184TC-5-4

EXPLOSION PROOF ELECTRIC MOTOR

NEMA PREMIUM EFFICIENCY

TOTALLY ENCLOSED FAN COOLED; EXPLOSION PROOF ENCLOSURE - C-FLANGE WITH FEET

CLASS I DIVISION I GROUP C & D; CLASS II DIVISION I GROUP F & G

T3C, with Ambient Temperature Rating: -20 ° C to 55 ° C @ 1.15 SF

T3C, with Ambient Temperature Rating: -20° C to 40° C @ 1.0 SF for Inverter Duty

UL NAME PLATE

 LISTED E310089		NO. XXXXXX ELECTRIC MOTOR FOR HAZARDOUS LOCATIONS	
Classes and Groups	Temp. code	Max. Amb.	Frame
CLASS I DIVISION 1 GROUP C D,	T3C	40°C, 55°C	140/180/210
CLASS II DIVISION 1 GROUP F G.	T3C	40°C	250~449
CLASS I DIVISION 1 GROUP C D.	T2B	55°C	250~449
Inverter Rated			
PWM - Constant Torque - 12 to 60 Hertz, Variable Torque - 6 to 60 Hertz when the input to the PWM is 480V/60Hz;			
PWM - Constant Torque - 10 to 50 Hertz, Variable Torque - 5 to 50 Hertz, when the input to the PWM is 380V/50Hz.			
NEMA MG1-Part 31		8AP.866.1102	

APPLICATIONS:

General purpose use on pumps, fans, blowers, compressors, conveyors, material handling and other industrial machinery installed in damp, dusty or dirty environments. These motors are designed to be used in hazardous locations as defined by class and group.