

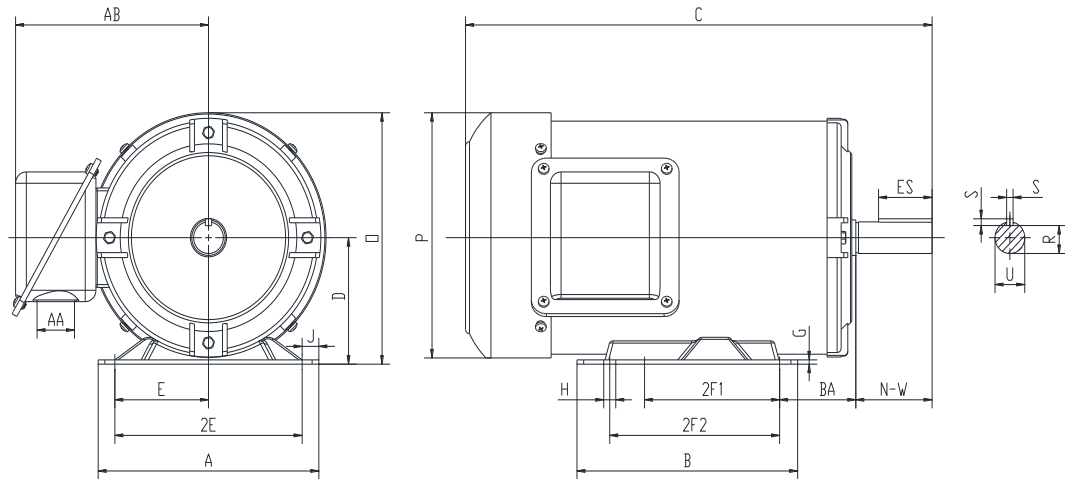

PR145T2M4A

GENERAL PURPOSE ELECTRIC MOTOR
NEMA PREMIUM EFFICIENCY
ROLLED STEEL CONSTRUCTION
TOTALLY ENCLOSED FAN COOLED
INVERTER RATED (10:1 VT; 5:1 CT)



DIMENSIONS

HP	RPM	Frame	MOUNTING														
			A	B	C	D	G	H	J	E	2E	2F1	2F2	O	P	T	BA
2	1800	145T	6.5	6.5	12.6	3.5	0.12	0.34	0.5	2.75	5.5	4	5	7	6.8	NA	2.25

Shaft Extension, Key Set						Conduit Box		Bearings		Mount
U	V	R	S	ES	N-W	AA	AB	DE	ODE	
0.875	NA	0.771	0.188	1.41	2.25	1.1	6	6205-2RZC3	6203-2RZC3	F1

BEARING LUBRICATION: The bearings come lubricated with Mobil Polyrex EM Polyurea Grease.





PR145T2M4A

GENERAL PURPOSE ELECTRIC MOTOR
NEMA PREMIUM EFFICIENCY
ROLLED STEEL CONSTRUCTION
TOTALLY ENCLOSED FAN COOLED
INVERTER RATED (10:1 VT; 5:1 CT)







PERFORMANCE DATA

HP	RPM	Frame	Voltage	Frequency (Hz)	Full Load S.F.	Insulation Class	NEMA Design	Slip (%)	NEMA Code	Enclosure Type	IP Rating	Max. Ambient
2	1740	145T	230/460	60	1.15	F	B	3.3	L	TEFC	55	40 °C

Amps (460V)		Efficiency (%)			Power Factor			Torque (ft-lb)			DE Bearing	ODE Bearing	Connection	Weight (lbs.)
FLA	LRA	100%	75%	50%	100%	75%	50%	FLT	LRT %	BDT %				
2.7	21.6	86.5	87.3	86.1	0.79	0.71	0.58	6.09	336	384	6205-2RZC3	6203-2RZC3	9 Lead 2Y/Y	40

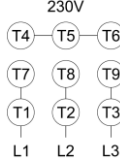
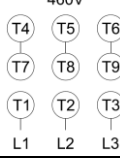
*Usable at 208 Volts

NAME PLATE

		THREE PHASE AC INDUCTION MOTOR					
CAT NO:	PR145T2M4A	FRAME	145T	PH	3	230V 	
HZ	60	S.F.	1.15	ENCL	TEFC	IP	55
HP	2	RPM	1740	DUTY	CONT	DES	B
VOLT	230/460	AMB	40 °C	INS	F	460V 	
FLA	5.2/2.7	DE BRG	6205-2RZC3				
CODE	L	P.F.	0.79	ODE BRG	6203-2RZC3		
EFF	86.5	MIN	84.0	LBS	40		
CONNECTION	9 Lead 2Y/Y	SER NO.					
Hernando, MS www.naemotors.com					CC340B		

APPLICATIONS:

General purpose use on pumps, fans, blowers, compressors, conveyors, material handling and other industrial machinery installed in damp, dusty or dirty environments.