

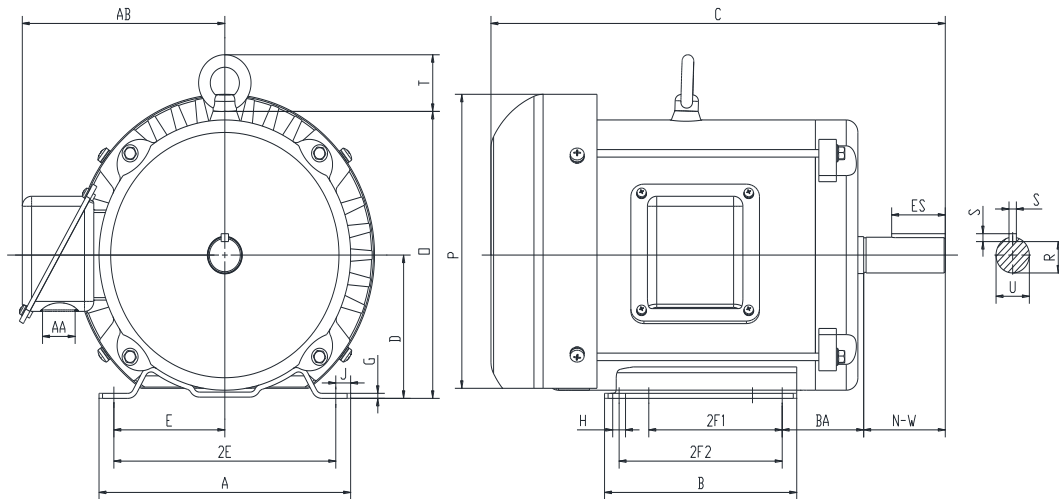

## PR182T3M4A

**GENERAL PURPOSE ELECTRIC MOTOR**  
**NEMA PREMIUM EFFICIENCY**  
**ROLLED STEEL CONSTRUCTION**  
**TOTALLY ENCLOSED FAN COOLED**  
**INVERTER RATED (10:1 VT; 5:1 CT)**



### DIMENSIONS

HP	RPM	Frame	MOUNTING														
			A	B	C	D	G	H	J	E	2E	2F1	2F2	O	P	T	BA
3	1800	182T	8.5	6.5	15.4	4.5	0.16	0.41	0.5	3.75	7.5	4.5	5.5	9.1	9.3	1.5	2.75

Shaft Extension, Key Set						Conduit Box		Bearings		Mount
U	V	R	S	ES	N-W	AA	AB	DE	ODE	
1.125	NA	0.986	0.25	1.78	2.75	1.1	7	6206-2RZC3	6205-2RZC3	F1

**BEARING LUBRICATION:** The bearings come lubricated with Mobil Polyrex EM Polyurea Grease.





## PR182T3M4A

**GENERAL PURPOSE ELECTRIC MOTOR**  
**NEMA PREMIUM EFFICIENCY**  
**ROLLED STEEL CONSTRUCTION**  
**TOTALLY ENCLOSED FAN COOLED**  
**INVERTER RATED (10:1 VT; 5:1 CT)**





### PERFORMANCE DATA

HP	RPM	Frame	Voltage	Frequency (Hz)	Full Load S.F.	Insulation Class	NEMA Design	Slip (%)	NEMA Code	Enclosure Type	IP Rating	Max. Ambient
3	1750	182T	230/460	60	1.15	F	B	2.8	J	TEFC	55	40 °C

Amps (460V)		Efficiency (%)			Power Factor			Torque (ft-lb)			DE Bearing	ODE Bearing	Connection	Weight (lbs.)
FLA	LRA	100%	75%	50%	100%	75%	50%	FLT	LRT %	BDT %				
4	25.7	89.5	90.1	88.9	0.82	0.77	0.68	9.04	226	361	6206-2RZC3	6205-2RZC3	9 Lead 2Y/Y	82

\*Usable at 208 Volts

### NAME PLATE

		THREE PHASE AC INDUCTION MOTOR								
CAT NO:	PR182T3M4A	FRAME	182T	PH	3	230V T4 T5 T6 T7 T8 T9 T1 T2 T3 L1 L2 L3				
HZ	60	S.F.	1.15	ENCL	TEFC				IP	55
HP	3	RPM	1750	DUTY	CONT				DES	B
VOLT	230/460	AMB	40 °C	INS	F	460V T4 T5 T6 T7 T8 T9 T1 T2 T3 L1 L2 L3				
FLA	8/4	DE BRG	6206-2RZC3							
CODE	J	P.F.	0.82	ODE BRG	6205-2RZC3					
EFF	89.5	MIN	87.5	LBS	82					
CONNECTION	9 Lead 2Y/Y		SER NO.							
Hernando, MS www.naemotors.com								<b>CC340B</b>		

### APPLICATIONS:

General purpose use on pumps, fans, blowers, compressors, conveyors, material handling and other industrial machinery installed in damp, dusty or dirty environments.