

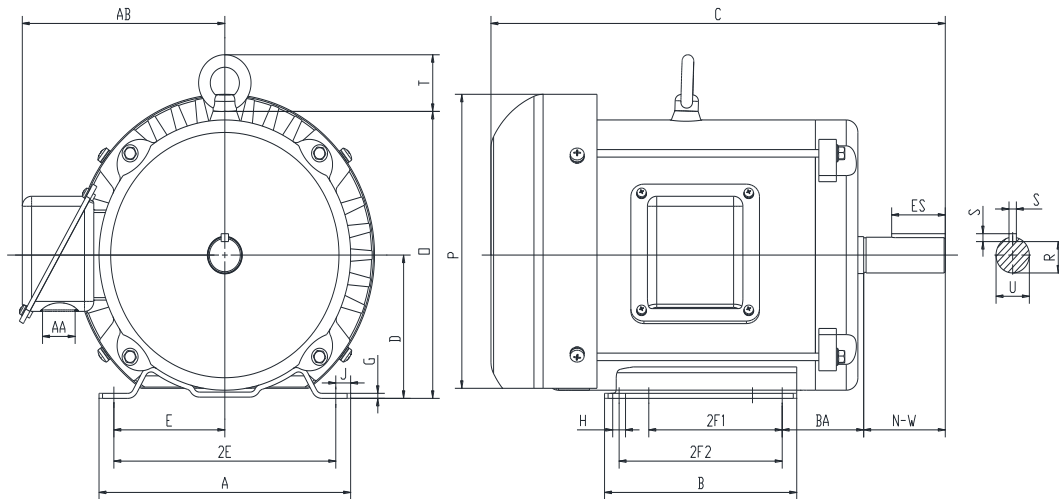

PR184T5M4A

GENERAL PURPOSE ELECTRIC MOTOR
NEMA PREMIUM EFFICIENCY
ROLLED STEEL CONSTRUCTION
TOTALLY ENCLOSED FAN COOLED
INVERTER RATED (10:1 VT; 5:1 CT)



DIMENSIONS

HP	RPM	Frame	MOUNTING														
			A	B	C	D	G	H	J	E	2E	2F1	2F2	O	P	T	BA
5	1800	184T	8.5	6.5	15.4	4.5	0.16	0.41	0.5	3.75	7.5	4.5	5.5	9.1	9.3	1.5	2.75

Shaft Extension, Key Set						Conduit Box		Bearings		Mount
U	V	R	S	ES	N-W	AA	AB	DE	ODE	
1.125	NA	0.986	0.25	1.78	2.75	1.1	7	6206-2RZC3	6205-2RZC3	F1

BEARING LUBRICATION: The bearings come lubricated with Mobil Polyrex EM Polyurea Grease.





PR184T5M4A







GENERAL PURPOSE ELECTRIC MOTOR
NEMA PREMIUM EFFICIENCY
ROLLED STEEL CONSTRUCTION
TOTALLY ENCLOSED FAN COOLED
INVERTER RATED (10:1 VT; 5:1 CT)

PERFORMANCE DATA

HP	RPM	Frame	Voltage	Frequency (Hz)	Full Load S.F.	Insulation Class	NEMA Design	Slip (%)	NEMA Code	Enclosure Type	IP Rating	Max. Ambient
5	1760	184T	208-230/460	60	1.15	F	B	2.2	K	TEFC	55	40 °C

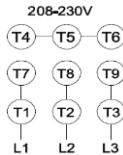
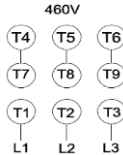
Amps (460V)		Efficiency (%)			Power Factor			Torque (ft-lb)			DE Bearing	ODE Bearing	Connection	Weight (lbs.)
FLA	LRA	100%	75%	50%	100%	75%	50%	FLT	LRT %	BDT %	6206-2RZC3	6205-2RZC3	9 Lead 2Y/Y	90
6.4	44.8	89.5	90.0	87.7	0.80	0.75	0.65	15.02	218	309				

NAME PLATE

		THREE PHASE AC INDUCTION MOTOR					
CAT NO:	PR184T5M4A	FRAME	184T	PH	3	208-230V 	
HZ	60	S.F.	1.15	ENCL	TEFC	IP	55
HP	5	RPM	1760	DUTY	CONT	DES	B
VOLT	208-230/460	AMB	40 °C	INS	F	460V 	
FLA	14.1-12.8/6.4	DE BRG	6206-2RZC3				
CODE	K	P.F.	0.80	ODE BRG	6205-2RZC3		
EFF	89.5	MIN	87.5	LBS	90		
CONNECTION	9 Lead 2Y/Y	SER NO.					
Hernando, MS www.naemotors.com					CC340B		

APPLICATIONS:

General purpose use on pumps, fans, blowers, compressors, conveyors, material handling and other industrial machinery installed in damp, dusty or dirty environments.