

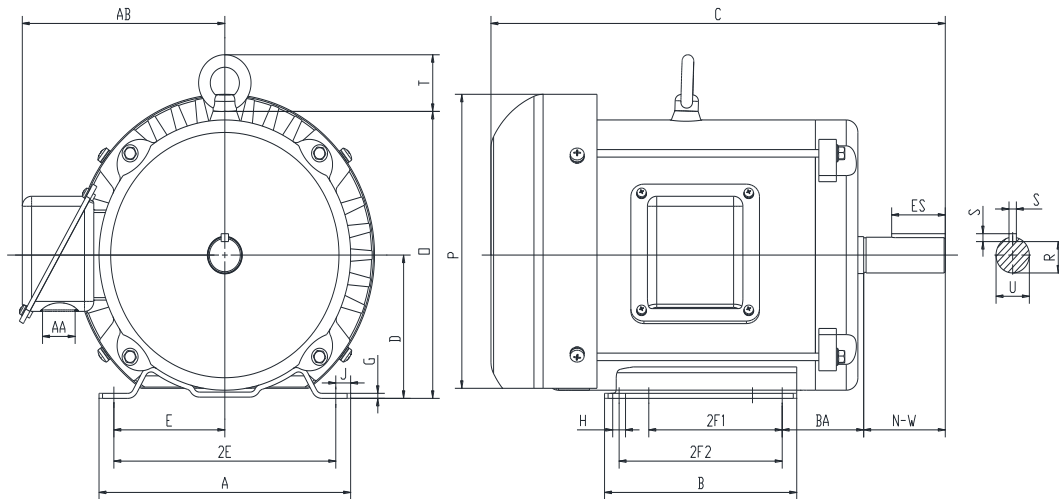

PR213T7.5M4A

GENERAL PURPOSE ELECTRIC MOTOR
NEMA PREMIUM EFFICIENCY
ROLLED STEEL CONSTRUCTION
TOTALLY ENCLOSED FAN COOLED
INVERTER RATED (10:1 VT; 5:1 CT)



DIMENSIONS

HP	RPM	Frame	MOUNTING														
			A	B	C	D	G	H	J	E	2E	2F1	2F2	O	P	T	BA
7.5	1800	213T	10.4	8.5	19	5.25	0.16	0.41	0.95	4.25	8.5	5.5	7	10	10.6	1.2	3.5

Shaft Extension, Key Set						Conduit Box		Bearings		Mount
U	V	R	S	ES	N-W	AA	AB	DE	ODE	
1.375	NA	1.201	0.312	2.41	3.38	1.38	8.1	6307-2RZC3	6206-2RZC3	F1

BEARING LUBRICATION: The bearings come lubricated with Mobil Polyrex EM Polyurea Grease.





PR213T7.5M4A







GENERAL PURPOSE ELECTRIC MOTOR
NEMA PREMIUM EFFICIENCY
ROLLED STEEL CONSTRUCTION
TOTALLY ENCLOSED FAN COOLED
INVERTER RATED (10:1 VT; 5:1 CT)

PERFORMANCE DATA

HP	RPM	Frame	Voltage	Frequency (Hz)	Full Load S.F.	Insulation Class	NEMA Design	Slip (%)	NEMA Code	Enclosure Type	IP Rating	Max. Ambient
7.5	1770	213T	208-230/460	60	1.15	F	B	1.7	H	TEFC	55	40 °C

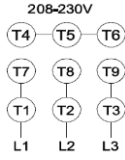
Amps (460V)		Efficiency (%)			Power Factor			Torque (ft-lb)			DE Bearing	ODE Bearing	Connection	Weight (lbs.)
FLA	LRA	100%	75%	50%	100%	75%	50%	FLT	LRT %	BDT %	6307-2RZC3	6206-2RZC3	9 Lead 2Y/Y	131
9.6	61.4	91.7	91.8	91.0	0.80	0.75	0.65	22.4	216	269				

NAME PLATE

		THREE PHASE AC INDUCTION MOTOR													
CAT NO: PR213T7.5M4A		FRAME	213T	PH	3										
HZ	60	S.F.	1.15	ENCL	TEFC	IP	55								
HP	7.5	RPM	1770	DUTY	CONT	DES	B								
VOLT	208-230/460			AMB	40 °C		INS	F							
FLA	20.5-19.2/9.6			DE BRG	6307-2RZC3										
CODE	H	P.F.	0.80	ODE BRG	6206-2RZC3										
EFF	91.7	MIN	90.2	LBS	131										
CONNECTION	9 Lead 2Y/Y			SER NO.											
Hernando, MS www.naemotors.com										CC340B					

APPLICATIONS:

General purpose use on pumps, fans, blowers, compressors, conveyors, material handling and other industrial machinery installed in damp, dusty or dirty environments.