

## SS56C1/3M-2

**WASHDOWN DUTY MOTOR**  
**HIGH EFFICIENCY / EISA COMPLIANT**  
**STAINLESS STEEL CONSTRUCTION - C-FLANGE WITH FEET**  
**TOTALLY ENCLOSED FAN COOLED - IP66 CONSTRUCTION**  
**INVERTER DUTY 10:1 CT; 20:1 VT - NEMA MG1 PART 31**

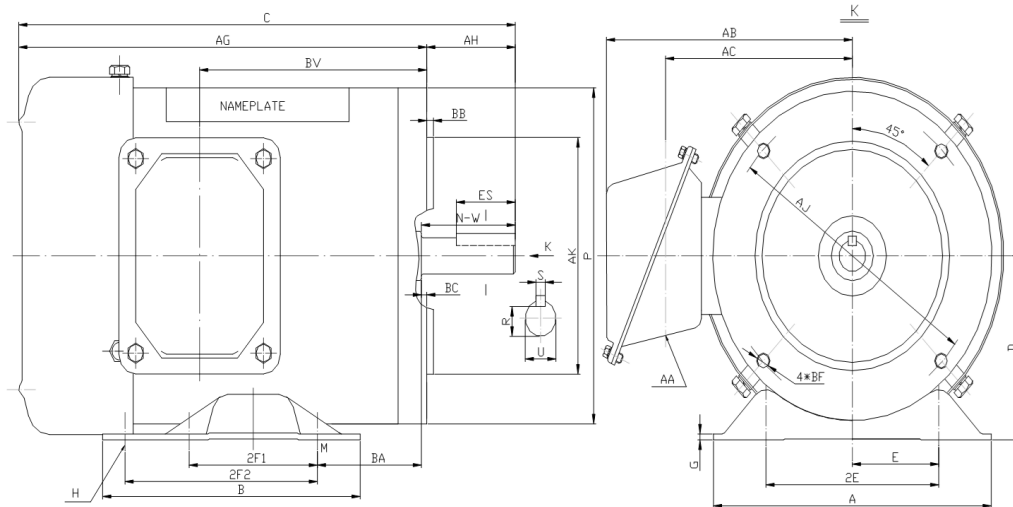

### DIMENSIONS

HP	RPM	Frame	MOUNTING												
			A	B	C	D	G	H	E	2E	2F1	2F2	P	AG	BA
1/3	3600	56C	6.5	5	11.59	3.5	0.118	1.22*0.34	2.44	4.88	3	NA	6.5	9.53	2.75

FLANGE						Shaft Extension, Key Set					Conduit Box			
AH	AJ	AK	BB	BC	BF	U	R	S	ES	N-W	AA	AB	AC	BV
2.06	5.875	4.5	0.16	-0.19	4*3/8-16	0.625	0.517	0.188	1.41	1.88	0.86	5.75	4.25	5.3

Bearings		Mount
DE	ODE	
6205-2RS	6205-2RS	F1

**BEARING LUBRICATIONS:** The sealed bearings come lubricated with NEVASTANE XS 80 Grease which complies with FDA Chapter 21 CFR 178.3570



## SS56C1/3M-2





**WASHDOWN DUTY MOTOR**  
**HIGH EFFICIENCY / EISA COMPLIANT**  
**STAINLESS STEEL CONSTRUCTION - C-FLANGE WITH FEET**  
**TOTALLY ENCLOSED FAN COOLED - IP66 CONSTRUCTION**  
**INVERTER DUTY 10:1 CT; 20:1 VT - NEMA MG1 PART 31**

### PERFORMANCE DATA

HP	RPM	Frame	Voltage	Frequency (Hz)	Full Load S.F.	Insulation Class	NEMA Design	Slip (%)	NEMA Code	Enclosure Type	IP Rating	Max. Ambient
1/3	3500	56C	208-230/460	60	1.15	F	B	2.8	K	TEFC	66	40 °C

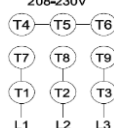
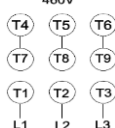
Amps (460V)		Efficiency (%)			Power Factor			Torque (ft-lb)			DE Bearing	ODE Bearing	Connection	Weight (lbs.)
FLA	LRA	100%	75%	50%	100%	75%	50%	FLT	LRT %	BDT %				
0.55	8	74.0	64.0	59.0	0.85	0.72	0.62	0.5	285	300	6205-2RS	6205-2RS	9 Lead 2Y/Y	26

### NAME PLATE

		THREE PHASE AC INDUCTION MOTOR						Hernando, MS 38632				
						INVERTER DUTY 20:1 VT; 10:1 CT						
Model :		SS56C1/3M-2				IP	66	FRAME	56C	LB/WT	26	
HZ	60	S.F.	1.15	HZ	50	S.F.	1.0	NEMA DESIGN		B		
HP	1/3	RPM	3500	HP	1/3	RPM	2880	ENCL.	TEFC	INS	F	
VOLTS		208-230/460			VOLTS		190/380		DUTY	CONT	AMB	40 °C
AMPS		1.2 - 1.1 / 0.55			AMPS		1.3/0.65		DE BRG		6205-2RS	
CODE	K	P.F.	0.85	CODE	K	P.F.	0.87	ODE BRG		6205-2RS		
EFF	74.0	MIN	71.0	EFF	71.5	MIN	69.0	SER NO.				
<div style="display: flex; justify-content: space-between;"> <div style="text-align: center;"> <p>208-230V</p>  </div> <div style="text-align: center;"> <p>460V</p>  </div> <div style="text-align: center;">    </div> <div style="text-align: center;"> <p>CC082A</p> <p>MADE IN CHINA</p> </div> </div>												

Factory Certified for T2B  
 Div 2. Class I, Gr. A , B , C & D  
 and Class II, Gr. F & G

### APPLICATIONS:

Applications include washdown applications, food processing, chemical processing, pharmaceuticals, poultry processing, meat processing, dairy applications, bakeries, snack foods, bottling and extremely corrosive environments.