

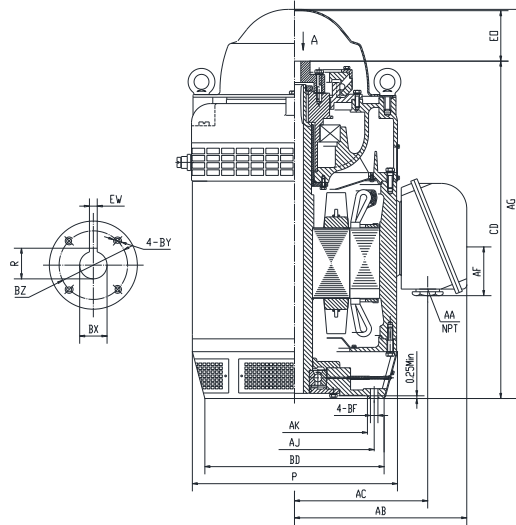

**V1-50D4-W32616A**

**VERTICAL HOLLOW SHAFT MOTOR**  
**NEMA PREMIUM EFFICIENCY**  
**INVERTER RATED 10:1 VT**  
**HIGH THRUST DESIGN**  
**THREE PHASE, OPEN DRIP PROOF (WP1) ENCLOSURE**  
**NON-REVERSE BALL TYPE RATCHET**  
**COUPLING INCLUDED**



**DIMENSIONS**

HP	RPM	Frame	MOUNTING DIMENSIONS													
			BD	AJ	AK	BF	BX	BZ	EW	R	BY	CD	E0 >	AC	AA	AF
50	1785	326TP	16.5	14.75	13.5	0.69	1-1/4	1.75	0.25	1.366	1/4-20	28.22	4.22	11.65	3	5.83

OVERALL DIMENSIONS			BEARINGS	
P	AB	AG	UPPER	LOWER
17.32	15.44	32.7	7221B	6213

**COUPLING:** Motor comes with a 1.25" coupling. You may select a different size coupling at no extra charge.

**BEARING LUBRICATION:** The lower bearing comes lubricated with Mobil Polyrex EM Polyurea Grease.

**OIL RESERVOIR:** Motor is shipped without oil. The oil capacity is 1.75 quarts.

**STEADY BUSHING:** Motor is designed to accept a steady bushing. The bore size is 1-1/4 inches.





## V1-50D4-W32616A

**VERTICAL HOLLOW SHAFT MOTOR**  
**NEMA PREMIUM EFFICIENCY**  
**INVERTER RATED 10:1 VT**  
**HIGH THRUST DESIGN**  
**THREE PHASE, OPEN DRIP PROOF (WP1) ENCLOSURE**  
**NON-REVERSE BALL TYPE RATCHET**  
**COUPLING INCLUDED**







### PERFORMANCE DATA

HP	RPM	Frame	Voltage	Frequency (Hz)	Full Load S.F.	Insulation Class	NEMA Design	Slip (%)	NEMA Code	Enclosure Type	IP Rating	Max. Ambient	Rating CONT
50	1785	326TP	230/460	60	1.15	F	B	0.83	H	WP1	23	40° C	S1

Amps (460V)		Efficiency (%)			Power Factor			Torque (ft-lb)			Down Thrust	Angular Contact Bearing	Radial Ball Bearing	Connection	Weight (lbs.)
FLA	LRA	100%	75%	50%	Min.	100%	75%	50%	FLT	LRT %	BDT %	UPPER	LOWER	12 Lead	811
56.4	445	94.5	94.2	93.0	93.6	0.87	0.84	0.76	145	235	270	5500	7221B	6213	2Δ/Δ

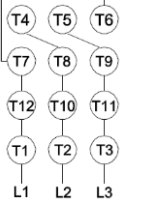
### NAME PLATE

 <b>VERTICAL HOLLOW SHAFT HIGH THRUST DESIGN</b> 						<b>CONNECTION DIAGRAMS</b>				
MODEL V1-50D4-W32616A						FRAME 326TP				
Hz	60	S.F.	1.15	ENCL	WP1	DESIGN	B			
HP	50	RPM	1785	INS	F	PHASE	3			
VOLTS	230/460	FLA	112.8/56.4	MAX.AMBIENT 40° C						
Enclosure	ODP	IP	23	RATING CONTINUOUS						
NEMA CODE	H	P.F.	0.87	MOTOR WEIGHT 811 LBS.						
NOM EFF	94.5	MIN EFF	93.6	CONNECTION 12 Lead 2Δ/Δ						
DOWN THRUST	5500			BASE DIAMETER 16.5 INCHES						
UPPER BEARING	7221B			LOWER BEARING 6213						
OIL CAP.	UPPER BEARING	1.75	QTS.	LUBRICATION MOBIL POLYREX EM						
NON-REVERSE RATCHET - BALL TYPE				SERIAL NO.						
Specifically designed for use on deep well turbine pump applications. Hernando, Mississippi						   CC326B				
ROTATION 						<b>PART WIND START CAPABLE @ 230V</b>				
<b>MOTOR IS SUITABLE FOR INVERTER RATED 10:1 VT</b>										

#### APPLICATIONS:

Specifically designed for use on deep well turbine pump applications. The coupling is equipped with a non-reverse ratchet, which prevents motor rotation from backspin at shutdown. These motors are built to NEMA standards and have special bearing arrangements to carry heavy thrust loads.